

INSTRUCTIONS

CWW-CABLES

FAIRFIELD

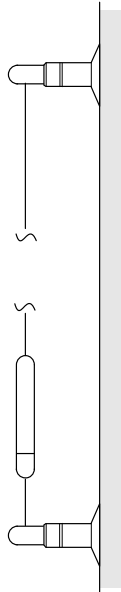

GUARANTEE

Cable / Rod components are manufactured to the highest possible standards of quality.

All our products are covered by a twelve month guarantee against any problems arising through faulty manufacture.

Should any problems be discovered, please contact your sales advisor in the first instance, on the relevant helpline number.

Your local Helpline

Head Office.01252 812211

North West Office.....01743 462472



Visit our Website on www.fairfielddisplays.co.uk

CEILING FIXINGS

CONCRETE

WOOD

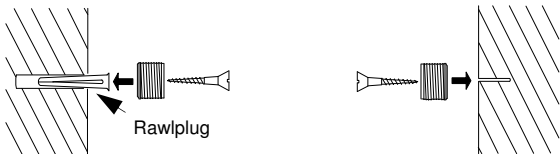

LATHE & PLASTER

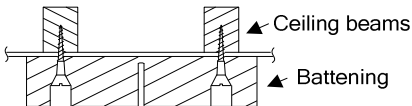

SUSPENDED CEILING

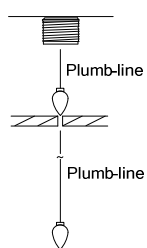

PLASTERBOARD

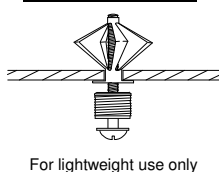

For lightweight use only

POCKET FIXING

Rear view

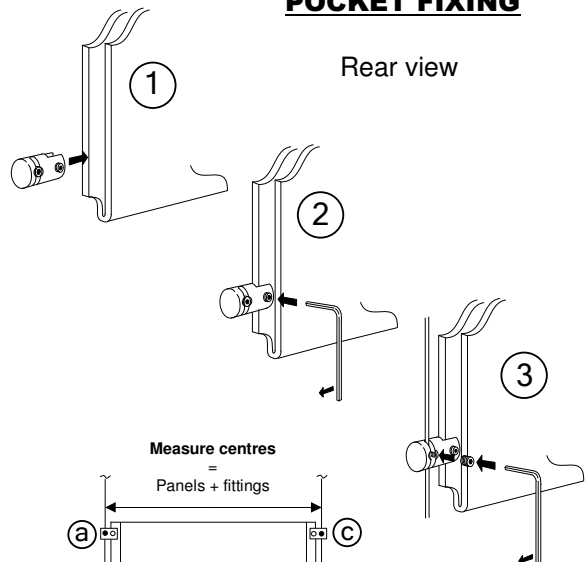

Measure centres

= Panels + fittings

Pocket / panel fitting sequence

Fitting tips

Wall to wall cables

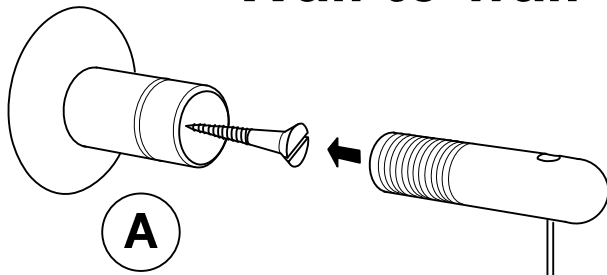

CWW cable installation

- 1] Fix base fitting **A** to wall:
 - for wooden walls use a wood screw.
 - for a cavity wall use a spring toggle bolt.
 - for a solid wall use a rawplug and screw.
- 2] Using a plumb-line, plumb down from **A** and fix base fitting **B** to wall.
- 3] Separate the two sections of part **C** and screw the two end sections into base fittings.
- 4] Loosen the two grub screws in the small brass fitting (**C1**) with the allen key provided and slide to the desired length. Re-tighten the grub screws and cut off the surplus cable about 4mm from the bottom of the fitting.
- 5] Re-connect the two sections of **C** and tighten to adjust tension.

N.B. It is important to check the strength of the of the top fixing. No responsibility will be taken for incorrect fixing. This responsibility rests with the installer. Cables are not supplied with fixing screws.

